

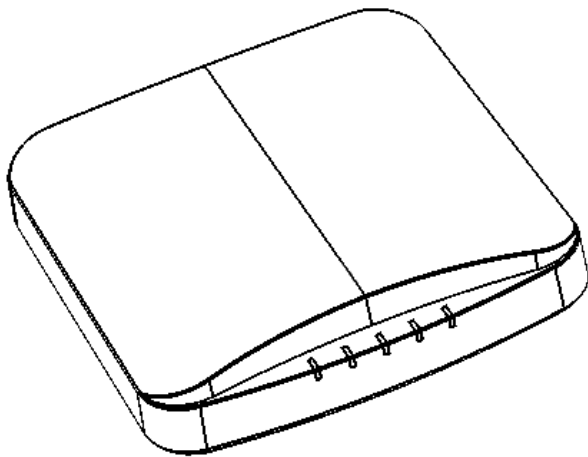

## RV35 Access Point Quick Setup Guide

This Quick Setup Guide provides step-by-step instructions on how to set up your RV35 access point. After completing the steps in this guide, you will be able to place the access point (AP) at your site and provide network access to wireless clients.

FIGURE 1 RV35: Top View



### Before You Begin

Before deploying please check for the latest software and the release documentation on our online portal.

### Package Contents

A complete Unleashed RV35 installation package includes all of the following items:

- RV35 Access Point
- One external T-bar bracket (two unassembled parts)
- One unit removal pin
- Declaration of Conformity/Regulatory Statement

### Unleashed Network Configuration

#### Setup Using the Unleashed Mobile App

To perform setup using the Unleashed Mobile App, download the iOS or Android app from the app store.

Scan here for iOS app



Scan here for Android app



1. As soon as the Unleashed AP is powered on and connected to the local network, it boots up and begins broadcasting a temporary unencrypted WLAN named "Configure.Me-[xxxxxx]" from both radios.
2. Using your client's Wi-Fi connection settings, select and associate to the "Configure.Me-[xxxxxx]" WLAN.
3. Launch the app, and follow the on-screen instructions to configure your Unleashed network(s).

FIGURE 2 Unleashed Mobile App for iOS and Android

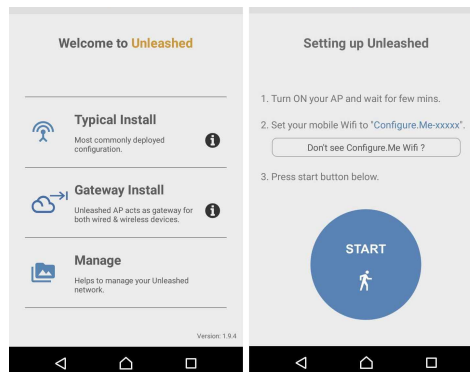
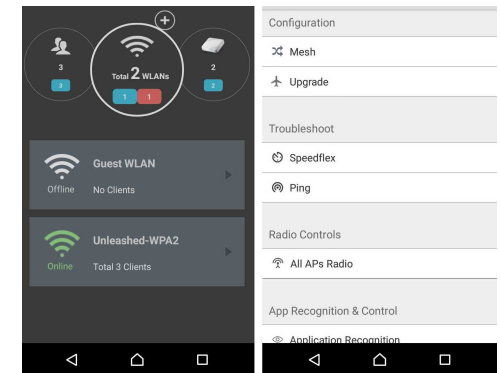

FIGURE 3 Configuring Unleashed from the Mobile App



### Setup Using a Web Browser

1. As soon as the Unleashed AP is powered on and connected to the local network, it boots up and begins broadcasting a temporary unencrypted WLAN named "Configure.Me-[xxxxxx]" from both radios.
2. Using your client's Wi-Fi connection settings, select and associate to the "Configure.Me-[xxxxxx]" WLAN.
3. Launch a web browser and enter the following into the browser's URL bar: [unleashed.rivinetworks.com](http://unleashed.rivinetworks.com), and press **Enter**.
4. You will be redirected to the Setup Wizard. Complete the steps in the Setup Wizard and click **Finish**.

FIGURE 4 Complete the Setup Wizard to set up your Unleashed network

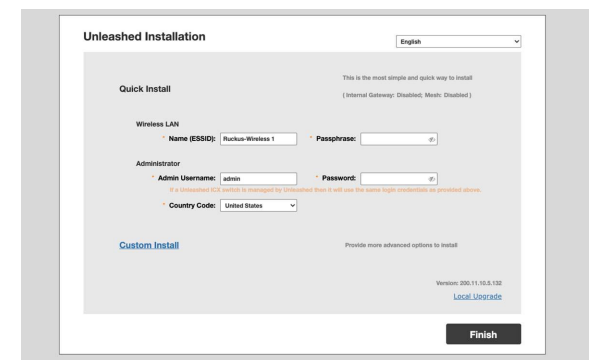

5. Once the Setup Wizard is finished, a "Configuring system settings and rebooting" progress screen appears. Wait until the process is complete.

6. Connect to the WLAN that you configured in the Setup Wizard, and click OK to reconnect. You will be redirected to the Unleashed login screen.

7. Enter your Admin Name and Password to login.

**FIGURE 5** The Login page

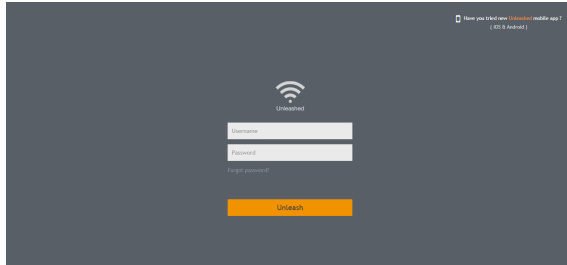

8. Upon successful login you will be presented with the Unleashed Dashboard, which displays an overview of your Unleashed network.

## Mounting the AP

The AP can be mounted on a flat surface, on a drop-ceiling T-bar.

### Mounting on a Flat Surface

The factory-supplied mounting screws and plastic wall anchors allow you to attach the AP to a wall or other flat surface.

1. Use the Mounting Template on the last page of this Quick Setup Guide to mark the locations for two drill holes on the mounting surface.
2. Use a 4.75-mm (3/16-in.) drill bit to drill holes approximately 25 mm (1 inch) deep into the mounting surface.
3. Insert the factory-supplied anchors (1 in [Figure 6](#)) and mounting screws (2 in [Figure 6](#)) into the mounting surface, leaving approximately 6 mm (1/4") of the screw heads protruding from the surface.

**FIGURE 6** Mounting the AP on Flat Surface

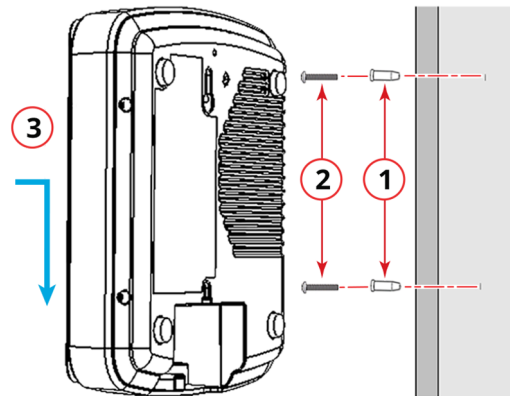

1. Factory-supplied anchors

2. Mounting screws

3. AP

4. Place the AP onto the mounting screws so that the screw heads enter the keyholes on the AP enclosure, and gently press down on the AP until the locking tab in the upper AP keyhole locks the AP onto the top mounting screw.

### Mounting on a Drop-Ceiling T-Bar

The factory-supplied T-bar mounting assembly kit allows you to attach the AP to recessed and flush drop-ceiling T-bars.

1. Position the studs on the bottom of the T-bar bracket (1 in [Figure 7](#)) in the keyholes on the AP enclosure (2 in [Figure 7](#)).
2. Slide the T-bar bracket away from the Ethernet ports on the bottom of the AP until the AP retainer tab snaps into place, trapping the T-bar bracket studs in the keyholes.

**FIGURE 7** Attaching the T-bar Bracket to the AP

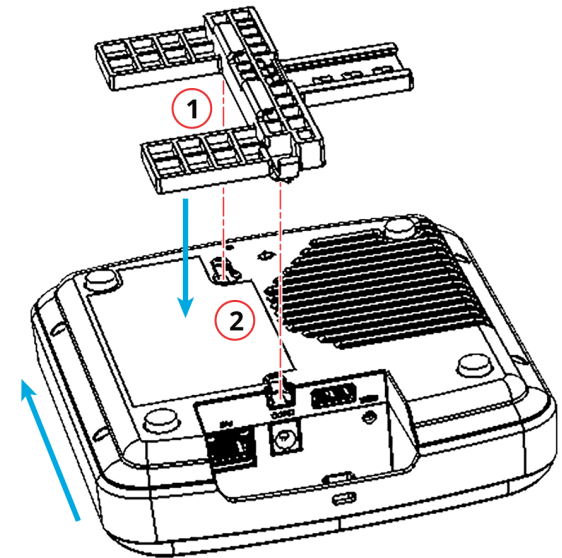

1. T-bar bracket studs

2. Key holes

3. Gently push the ceiling tiles, if present, up and out of the way.
4. Position the T-bar bracket (1 in [Figure 8](#)) so its two clasps grip one edge of the T-bar (2 in [Figure 8](#)). Make sure that both clasps are gripping the T-bar.
5. Hold the AP in place and gently push the locking tab (3 in [Figure 8](#))

**NOTE:** Make sure that all three clasps are gripping the T-bar.

**FIGURE 8** Attaching the AP and T-bar Bracket with the Locking Tab

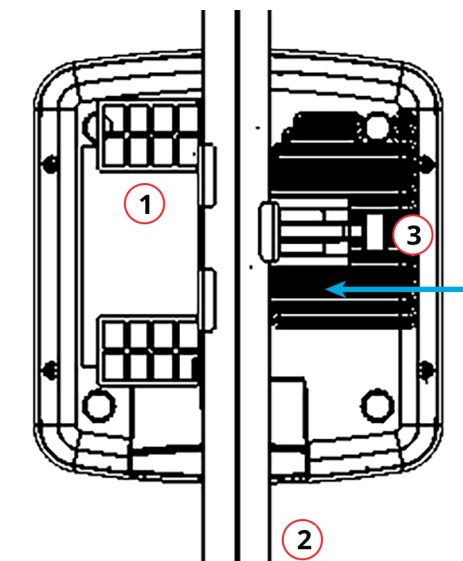

1. T-bar  
bracket

2. T-bar

3. Locking tab

## Troubleshooting

**CAUTION!** If required, you can reset the AP to its factory default settings by pressing the reset button. Use the tip of a pen or a 3-mm flat-blade screwdriver to press the reset button. Press and hold the reset button for 4 seconds or longer to restore to factory defaults. DO NOT RESET THE AP TO FACTORY DEFAULT SETTINGS UNLESS SO INSTRUCTED.

**NOTE:** After a reset, you can access the internal AP web interface using <https://192.168.0.1>. Your device must use any other address from 192.168.0.2 through 192.168.0.254, with subnet mask 255.255.255.0. The username is super, and the password is sp-admin.

